



Installation instructions, accessories

Volvo Car Corporation Gothenburg, Sweden

Instruction No	Version	Part. No.
31664558	1.0	31470795

Mudflaps, rear



Installation instructions, accessories

Volvo Car Corporation Gothenburg, Sweden

Equipment

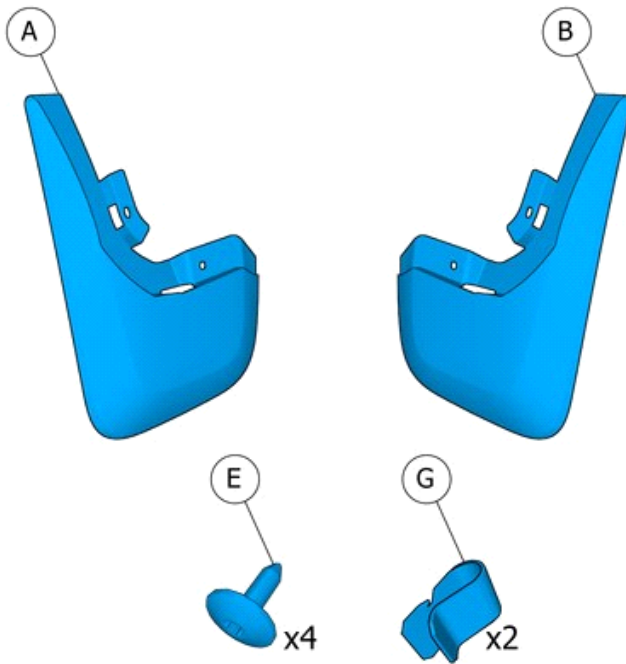

IMG-423647



Installation instructions, accessories

Volvo Car Corporation Gothenburg, Sweden

Information

1

Read through all of the instructions before starting installation.

Notifications and warning texts are for your safety and to minimise the risk of something breaking during installation.

Ensure that all tools stated in the instructions are available before starting installation.

Certain steps in the instructions are only presented in the form of images. Explanatory text is also given for more complicated steps.

In the event of any problems with the instructions or the accessory, contact your local Volvo dealer.

Color symbols

2

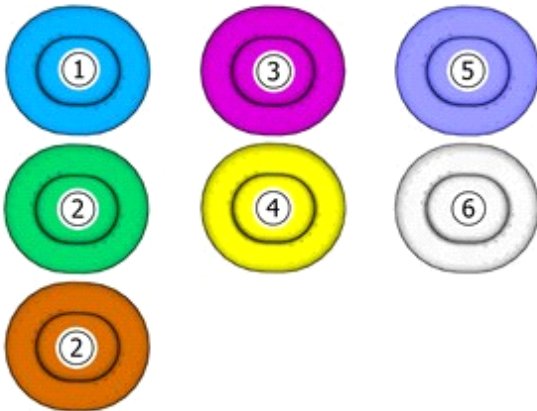

IMG-363036

Note!

This colour chart displays (in colour print and electronic version) the importance of the different colours used in the images of the method steps.

- Used for focused component, the component with which you will do something.
- Used as extra colors when you need to show or differentiate additional parts.
- Used for attachments that are to be removed/installed. May be screws, clips, connectors, etc.
- Used when the component is not fully removed from the vehicle but only hung to the side.
- Used for standard tools and special tools.
- Used as background color for vehicle components.

Removal



Installation instructions, accessories

Volvo Car Corporation Gothenburg, Sweden

3 Remove the marked part.

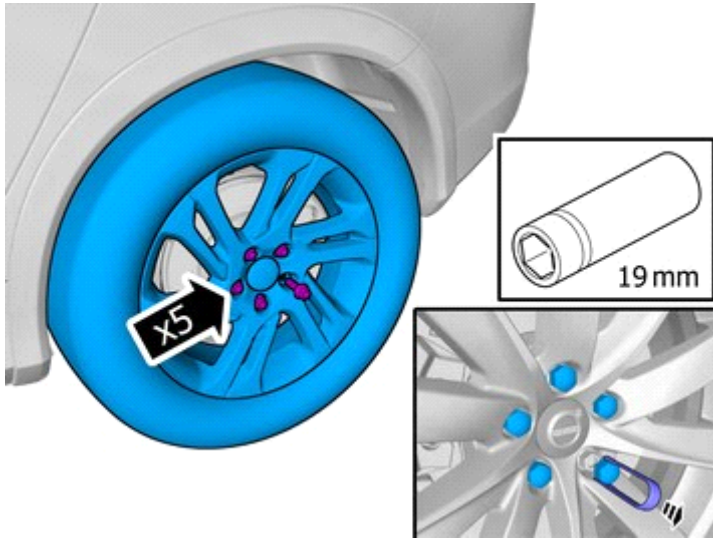

IMG-419952

4 Remove the screws.

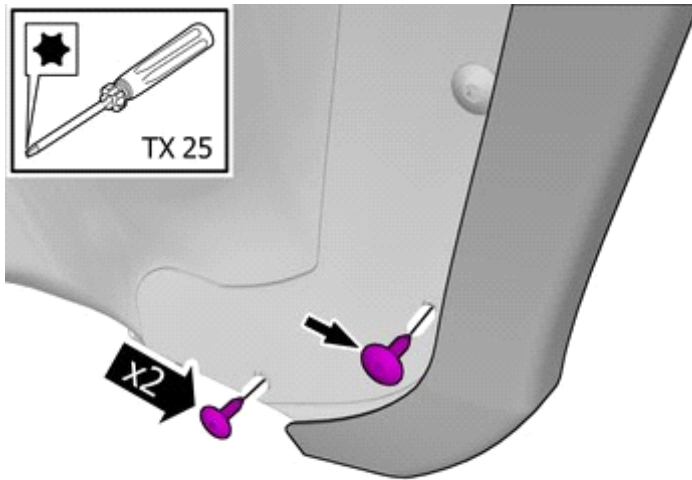

IMG-419985

Accessory installation



Installation instructions, accessories

Volvo Car Corporation Gothenburg, Sweden

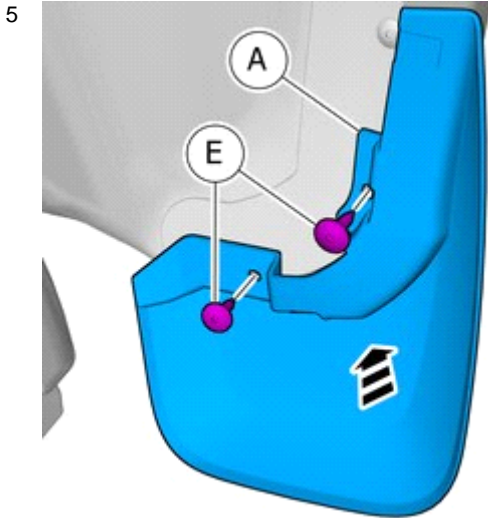

IMG-419986

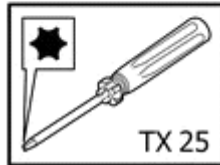

Caution!

Make sure that the components are positioned correctly.

Install component that comes with the accessory kit.

Tighten the bolts.

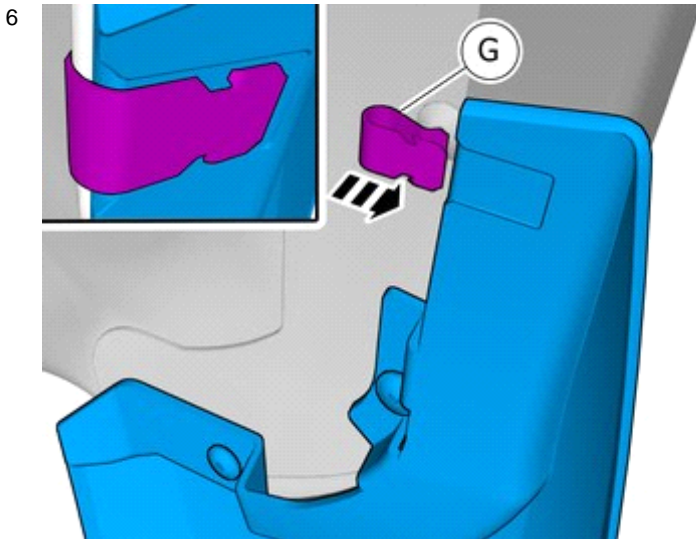

IMG-422999

Caution!

Check that the component has locked in its bottom position.

Install component that comes with the accessory kit.

Use: Interior trim remover

7

Repeat all method steps for the other side.

Installation

8

Reinstall the removed parts in reverse order.



Installation instructions, accessories

Volvo Car Corporation Gothenburg, Sweden

9

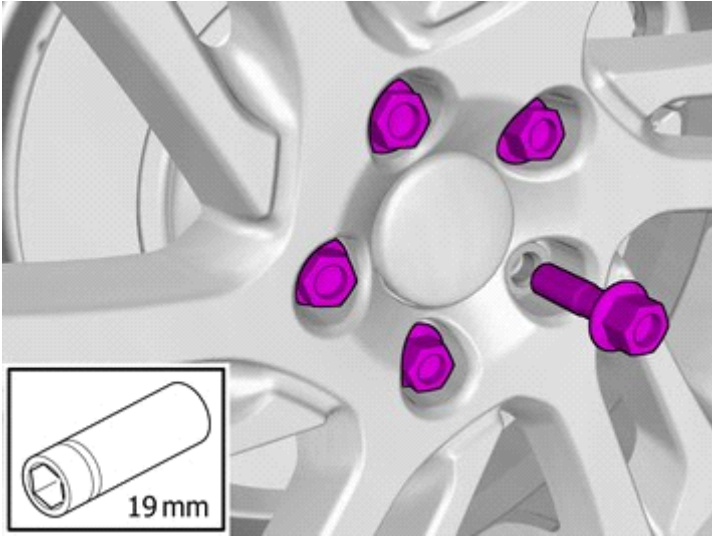

IMG-419953

Tightening torque: Wheel to wheel hub
Stage 1: 20 Nm
Stage 2: 140 Nm